

VALVE BODY TYPE I40, TC/TC

ART. NO. 310002

GENERAL



The KEOFIT CLASSIC "INGOLD" Sampling Valve owes its hygienic design and one-piece construction to the original KEOFIT valve. For 40 MM Ingold ports.



The product to be sampled should have a maximum viscosity of 0-1.000 cP and should not contain particles larger than 2 mm diameter.



The valve can be sterilized by means of SIP (EHEDG test) and cleaned by means of CIP (EHEDG certified).



The sampling valve can be used for any process sampling for microbiological, chemical and/or physical analysis.

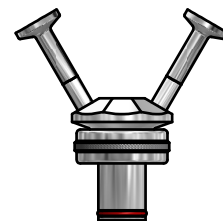

FEATURES



Installation: 40 mm Ingold port



Inlet / Outlet: Mini Tri-Clamp



Operation: Depending on choice of valve head



Membrane: Depending on choice of valve head

CERTIFICATION*

· Conforms to 3-A · EHEDG CIP · 3.1 Material Certificate · EU 1935/2004 · RA certificate

TECHNICAL DATA

Material (product contact)

- Steel parts AISI 316L (1.4435 BNII)
- O-ring Silicone (FDA · EU 1935/2004)

Material (without product contact)

- Steel parts AISI 316L (1.4435 BNII)

Surface Treatment

- Outside Electropolished Ra ≤ 1.2 µm
- Inside Ra ≤ 0.2 µm
- Process connection Electropolished Ra ≤ 0.2 µm

Pressure & Temperature

- Pressure Depending on choice of valve head
- Temperature Depending on choice of valve head
- Air supply -

Net Weight







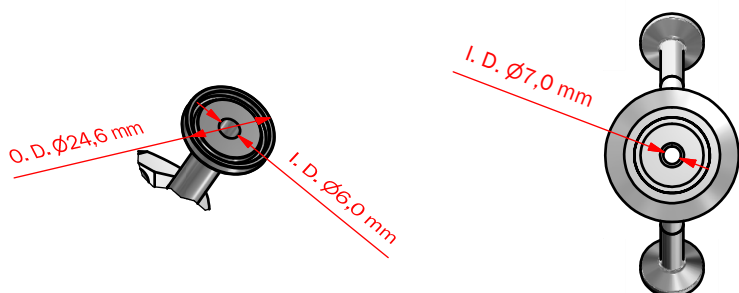
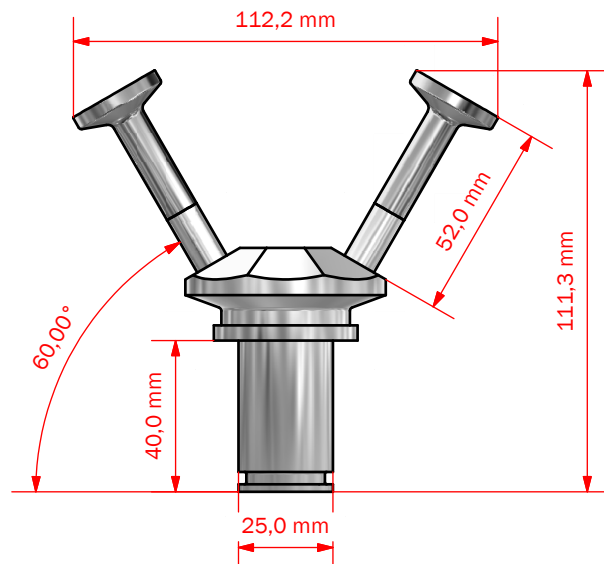
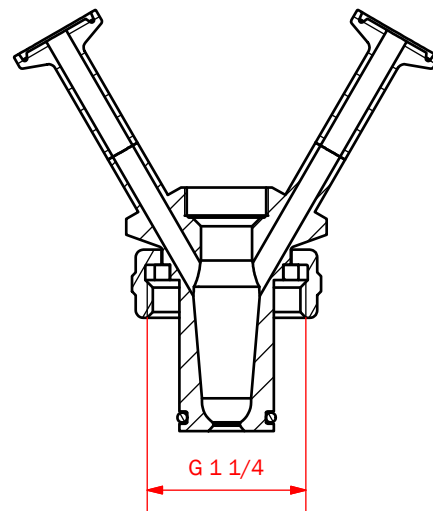





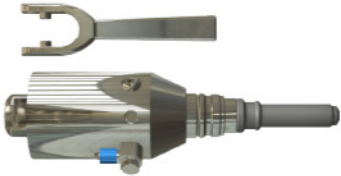





- Kg/lbs N/A / 1,03 lbs

Spareparts

- 300119 10 PACK O-RING 20,24 x 2,62 FDA



INGOLD & HEADS

For 40 mm Ingold port			For 52 mm Ingold port		
Type H	Type Q	Type N	Type H	Type Q	Type N
Turn knob 0-6 bar(g)	Lever handle 0-6 bar(g)	Lever handle Pneumatic 0-6 bar(g)	Turn knob 0-6 bar(g)	Lever handle 0-6 bar(g)	Lever handle Pneumatic 0-6 bar(g)
 310041	 310043	 310044	 320041	 320043	 320044
 310041E	 310043E	 310044E	 320041E	 320043E	 320044E
 315541	 315543	 315544	 325541	 325543	 325544