

VALVE HEAD I52 TYPE H

ART. NO. 320041

GENERAL

- The KEOFIT CLASSIC "INGOLD" Sampling Valve owes its hygienic design and one-piece construction to the original KEOFIT valve. Unique serial no. for each valve*.
- The sampling valve can be used for any process sampling for microbiological, chemical and/or physical analysis.
- Cleaning/sterilizing: Between batches: Valve in open position: Cleanable by means of CIP using the detergent solution suitable for the actual process media. Between samples: Valve in its normal closed position: cleanable by CIP as "Between batches" or the valve may be sterilized by means of steam SIP or chemical SIP using a procedure appropriate to the actual circumstances. For further advice, please contact Keofitt. Not recommended for autoclave due to plastic parts.
- Designed for sampling of liquids with a viscosity of up to approx. 1.000 cP containing no particles larger than Ø2 mm. Sampling of more viscous liquids is possible, only will it take longer (depending on process pressure).

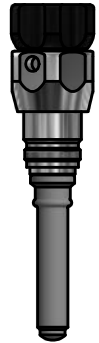

FEATURES

- Installation: Threaded connection (I52)
- Operation: Turn knob - spring loaded (opens counterclockwise)
- Membrane: Silicone (#320051)

CERTIFICATION*

- EU EC 1935/2004 · EU EC 2023/2006 · DK No. 1248 10/2018 · ATEX 2014/34/EU
- PED 2014/68/EU · FDA CFR 21 §177.2600 · USP Class VI · Keofitt DoC

TECHNICAL DATA

Material (process contact)

- Membrane SILICONE, GREY (#320051)

Material (without process contact)

- Steel parts AISI 303 (1.4305) / AISI 316L (1.4404)
- Knob PA6 (Black)

Membrane

- Article SILICONE, GREY (#320051)
- Certification*
 - EU EC 1935/2004 · EU EC 2023/2006
 - DK No. 1248 10/2018 · FDA CFR 21 §177.2600 · USP Class VI
 - REACH · RoHS · ADI Free · Keofitt DoC

Pressure & Temperature

- Pressure 0 - 10 bar / 0 - 145 psi
- Temperature 1 - 130°C / 34 - 266°F
- Air supply -

Net Weight

- kg/lbs 0.288 kg/0.634 lbs

Spareparts

- 773241 PARTS FOR I52 HEAD 320041/43

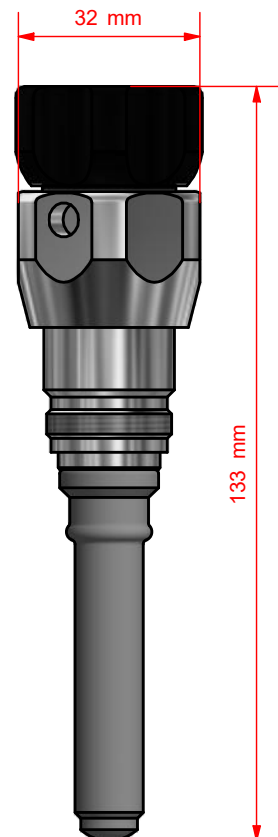

*For further information and download please visit www.keofitt.dk

KEOFITT CLASSIC “INGOLD” SAMPLING VALVE - BODIES

INGOLD BODIES		
	HOSE PIECE	MINI TRI-CLAMP
STANDARD FOR 40 MM PORT LENGTH*		
	On request	310002
	On request	310005
	On request	On request

* OTHER PORT LENGTH - AVAILABLE ON REQUEST



STANDARD FOR 52 MM PORT LENGTH*		
	On request	320002
	On request	320005
	On request	320007

* OTHER PORT LENGTH - AVAILABLE ON REQUEST

