

VALVE BODY W9 VARIVENT Ø68

ART. NO. 850009

GENERAL

- The KEOFIT CLASSIC W9 Sampling Valve is the original and leading sterilizable sampling valve in the world. Used in all industries for decades. More than 320 standard valve configurations. Unique serial no. for each valve*.
- The sampling valve can be used for any process sampling for microbiological, chemical and/or physical analysis.
- Cleaning/sterilizing: Between batches: Valve in open position: Cleanable by means of CIP using the detergent solution suitable for the actual process media. Between samples: Valve in its normal closed position: cleanable by CIP as "Between batches" or the valve may be sterilized by means of steam SIP or chemical SIP using a procedure appropriate to the actual circumstances. For further advice, please contact Keofitt.
- Designed for sampling of liquids with a viscosity of up to approx. 1.000 cP containing no particles larger than Ø3 mm. Sampling of more viscous liquids is possible, only will it take longer (depending on process pressure).

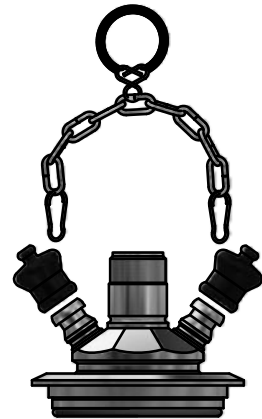

FEATURES

- Installation: Varivent Ø68 connection
- Operation: Depending on choice of valve head
- Inlet / Outlet: Hose piece
- Membrane: Depending on choice of valve head

CERTIFICATION*

- EU EC 1935/2004 • EU EC 2023/2006 • DK No.822 06/2013 • 3-A Certificate • 3.1 Material Certificate • Ra Certificate
- ATEX 94/9/EC & 2014/34/EU • PED 2014/68/EU • EHEDG (2007) • Keofitt DoC

TECHNICAL DATA

Material (product contact)

- Steel parts AISI 316L (1.4404)
- O-ring EPDM, BLACK (#400208)
- EU EC 1935/2004 • EU EC 2023/2006 • DK No.822 06/2013
- FDA CFR 21 §177.2600 • USP Class VI • ADI Free • Keofitt DoC

Material (without product contact)

- Steel parts AISI 316L (1.4404)
- Rubber cap EPDM (black)
- Stainless steel chain AISI 316L (1.4404)

Surface Treatment

- Outside Electropolished Ra ≤ 1.2 µm
- Inside (wetted surface) Electropolished Ra ≤ 0.5 µm
- Process connection Electropolished Ra ≤ 0.5 µm

Pressure & Temperature

- Pressure Depending on choice of valve head
- Temperature Depending on choice of valve head
- Air supply Depending on choice of valve head

Net Weight

- kg/lbs 0.775 kg/1.708 lbs





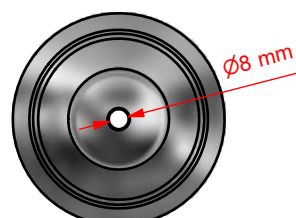
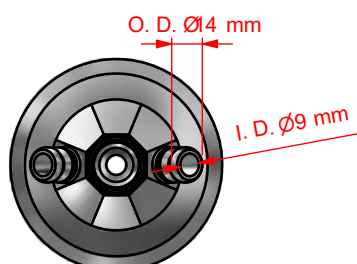
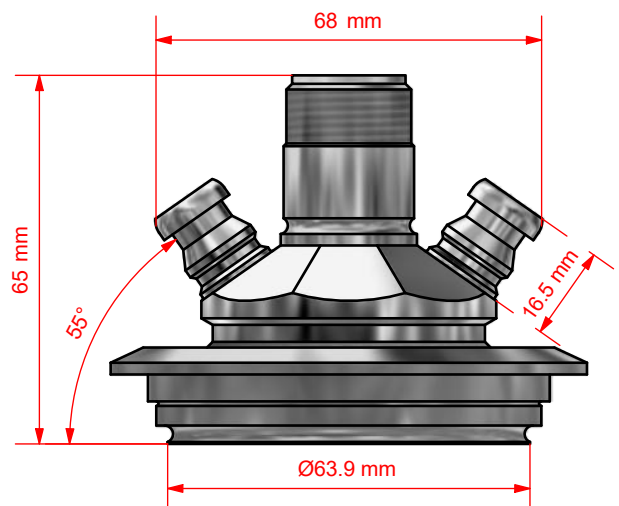











Spareparts

- 778509 PARTS FOR W9 BODY 850009



*For further information and download please visit www.keofitt.dk

KEOFITT CLASSIC W9 SAMPLING VALVE - HEADS

W9 HEADS					
	Type H Turn knob	Type H Turn knob with Microport option	Type K Key ring	Type K Key ring with Microport option	
Silicone	 600041	 600048	 600042	 600049	Type Q Lever handle 600043
EPDM	 600041E	 600048E	 600042E	 600049E	Type N Pneumatic 0-6 bar 600044
FFKM	 600041F	 Not available	 600042F	 Not available	Type N Pneumatic, Adjustable 0-6 bar 600045
PTFE	 855541	 Not available	 855542	 Not available	Type B No spring 0-12 bar(g) 600047
					Type N Pneumatic 0-6 bar 600044F
					Type N Pneumatic, Adjustable 0-6 bar 600045F
					Type B No spring 0-12 bar(g) 855547