

VALVE HEAD W25 TYPE B PTFE

ART. NO. 875547

GENERAL

- The KEOFITT CLASSIC W25 Sampling Valve is the largest KEOFITT sterilizable sampling valve. Designed for very high viscosity sampling. Unique serial no. for each valve*.
- The sampling valve can be used for any process sampling for microbiological, chemical and/or physical analysis.
- Cleaning/sterilizing: Between batches: Valve in open position: Cleanable by means of CIP using the detergent solution suitable for the actual process media. Between samples: Valve in its normal closed position: cleanable by CIP as "Between batches" or the valve may be sterilized by means of steam SIP or chemical SIP using a procedure appropriate to the actual circumstances. For further advice, please contact Keofitt. Not recommended for autoclave due to plastic parts.
- Designed for sampling of liquids with a viscosity of up to approx. 250.000 cP containing no particles larger than Ø17 mm. Sampling of more viscous liquids is possible, only will it take longer (depending on process pressure).

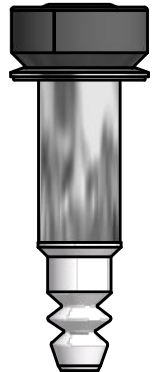

FEATURES

- Installation: Clamp connection (clamp ring included, #900187)
- Operation: Turn knob - no spring (opens counterclockwise)
- Membrane: PTFE (#870055)

CERTIFICATION*

- EU EC 1935/2004 · EU EC 2023/2006 · EU EC 10/2011 · DK No. 1248 10/2018 · ATEX 2014/34/EU
- PED 2014/68/EU · FDA CFR 21 §177.1550 · USP Class VI · Keofitt DoC

TECHNICAL DATA

Material (process contact)

- Membrane PTFE, WHITE (#870055)

Material (without process contact)

- Steel parts AISI 316L (1.4404) / AISI 304 (1.4301)
- Knob HDPE (black)

Membrane

- Article PTFE, WHITE (#870055)
- Certification*
 - EU EC 1935/2004 · EU EC 2023/2006 · EU EC 10/2011
 - DK No. 1248 10/2018 · FDA CFR 21 §177.1550 · USP Class VI
 - ADI Free · Keofitt DoC

Pressure & Temperature

- Pressure 0 - 12 bar / 0 - 174 psi
- Temperature 1 - 150°C / 34 - 302°F
- Air supply -

Net Weight

- kg/lbs 1.632 kg/3.595 lbs

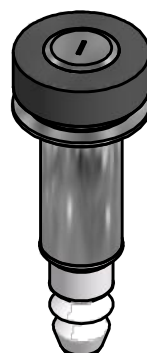
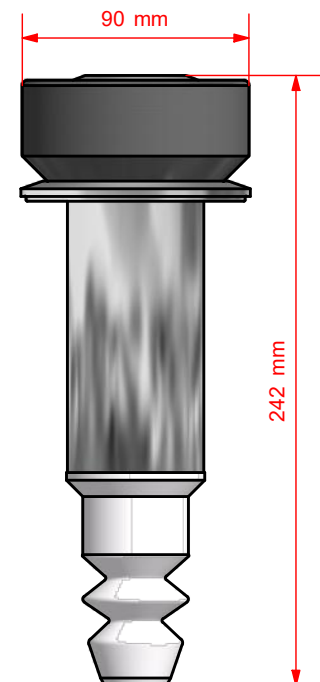

Spareparts

- 778747 PARTS FOR W25 HEAD 875547/44



*For further information and download please visit www.keofitt.dk

KEOFITT CLASSIC W25 SAMPLING VALVE - BODIES

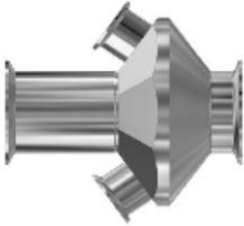
W25 BODIES		WELDING BODIES		CONNECTION BODIES	
WELDING LINER	1" CLAMP	TANK WELDING	PIPE WELDING	VARIVENT Ø68	CLAMP 3"
		 8700001	 On request	 8700009	 8700003

- 48 -

IV >

IV >

- 49 -

