

# QUICK COUPLING KSB OUTLET ST. ST. PLUG

ART. NO. 150061

## GENERAL



KEOFITT has the widest selection of spare parts and accessories to complete your sampling system.



Compatible to KEOFIT sampling bags.

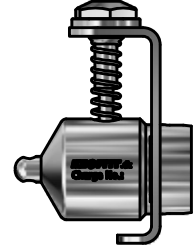

## FEATURES



Connection: KSB outlet



To be used with steel chain

## CERTIFICATION\*

· 3.1 Material Certificate

## TECHNICAL DATA

### Material (process contact)

### Material (without process contact)

- |               |  |
|---------------|--|
| · Steel parts | AISI 316L (1.4404)                       |
| · O-ring      | Silicone, RED (#800830)                  |
|               | · EU EC 1935/2004 · FDA CFR 21 §177.2600 |
|               | · USP Class VI · ADI Free                |

### Surface Treatment

- |           |                             |
|-----------|-----------------------------|
| · Outside | Electropolished Ra ≤ 1.2 µm |
| · Inside  | Electropolished Ra ≤ 0.5 µm |

### Pressure & Temperature

- |               |                                   |
|---------------|-----------------------------------|
| · Pressure    | Depending on choice of valve head |
| · Temperature | Depending on choice of valve head |

### Net Weight

- |          |                    |
|----------|--------------------|
| · kg/lbs | 0.045 kg/0.098 lbs |
|----------|--------------------|

### Spareparts

- |        |                                    |
|--------|------------------------------------|
| 800830 | 10 PACK O-RING SILICONE 10.3 x 2.4 |
|--------|------------------------------------|

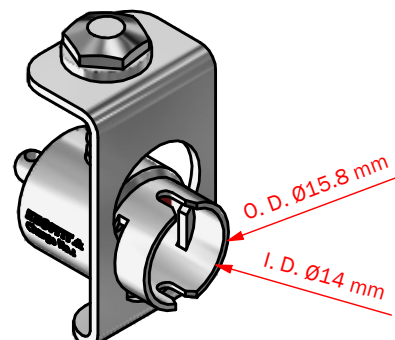
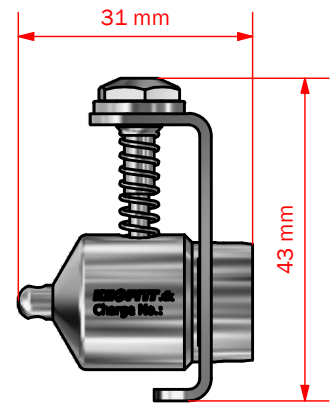

\*For further information and download please visit [www.keofitt.dk](http://www.keofitt.dk)