

# BASIX VALVE TYPE C 1" DIN/H

ART. NO. 452241

## GENERAL

- The KEOFIT BASIX Sampling Valve is our CIP-able sampling valve for less demanding applications. Replaces non-hygienic sampling cocks. More than 20 different configurations available.
- The sampling valve can be used for any process sampling for chemical and/or physical analysis.
- Cleaning: Valve in open position: Cleanable by means of CIP using the detergent solution suitable for the actual process media. For further advice, please contact Keofitt. Not recommended for autoclave due to plastic parts.
- Designed for sampling of liquids with a viscosity of up to approx. 100 cP containing no particles larger than Ø1.5 mm. Sampling of more viscous liquids is possible, only will it take longer (depending on process pressure).

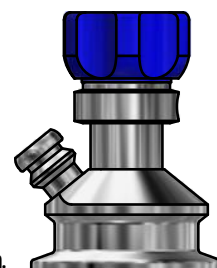

## FEATURES

- Installation: 1" Clamp DIN 32676:2009-05 Table 4 Row C, can be fitted for NA-connect acc. DIN Outlet: Hose piece
- Operation: Turn knob - spring loaded (opens counterclockwise)
- Membrane: Silicone (#400051)
- Head assembly: Hand tight using a tommy bar or maximum 15 Nm. Tommy bar included (#900118).

## CERTIFICATION\*

- EU EC 1935/2004 · EU EC 2023/2006 · DK No. 1248 10/2018 · 3-A Certificate · 3.1 Material Certificate
- ATEX 2014/34/EU · PED 2014/68/EU · FDA CFR 21 §177.2600 · USP Class VI · Keofitt DoC

## TECHNICAL DATA

### Material (process contact)

- Steel parts AISI 316L (1.4404)
- Membrane SILICONE, GREY (#400051)

### Material (without process contact)

- Steel parts AISI 304 (1.4307)
- Knob PA6 (Blue)

### Membrane

- Article SILICONE, GREY (#400051)
- Certification\* · EU EC 1935/2004 · EU EC 2023/2006 · DK No. 1248 10/2018 · FDA CFR 21 §177.2600 · USP Class VI · REACH · RoHS · ADI Free · Keofitt DoC

### Surface Treatment

- Outside  $R_a \leq 1.2 \mu m$
- Inside (wetted surface)  $R_a \leq 0.8 \mu m$
- Process connection  $R_a \leq 0.8 \mu m$

### Pressure & Temperature

- Pressure 0 - 6 bar / 0 - 87 psi
- Temperature 1 - 130°C / 34 - 266°F
- Air supply -

### Net Weight

- kg/lbs 0.378 kg/0.832 lbs

### Spareparts

- 774501 PARTS FOR BASIX VALVE BODY
- 774441 PARTS FOR 4KAI/BASIX HEAD H

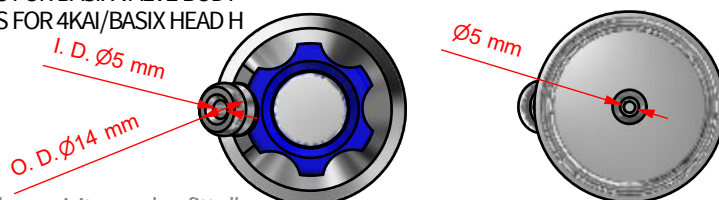
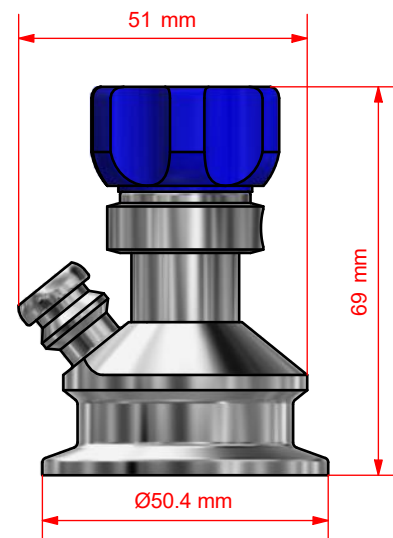

\*For further information and download please visit [www.keofitt.dk](http://www.keofitt.dk)

KEOFITT A/S reserves the right to change technical data without notice! Valid version of the data sheets is available on [www.keofitt.dk](http://www.keofitt.dk).