

# QUICK COUPLING KSB INLET 1" CLAMP

ART. NO. 150085

## GENERAL



KEOFITT has the widest selection of spare parts and accessories to complete your sampling system.



Compatible to KEOFIT sampling bags.

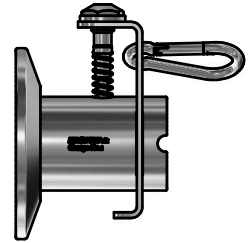

## FEATURES



Connection: KSB inlet 1" clamp

## CERTIFICATION\*

- 3.1 Material Certificate

## TECHNICAL DATA

### Material (process contact)

### Material (without process contact)

- Steel parts: AISI 316L (1.4404)
- Carabiner: Stainless steel
- O-ring: Silicone, RED (#150830)
  - EU EC 1935/2004 · FDA CFR 21 §177.2600
  - USP Class VI · ADI Free

### Surface Treatment

- Outside: Electropolished  $R_a \leq 1.2 \mu m$
- Inside: Electropolished  $R_a \leq 0.5 \mu m$

### Pressure & Temperature

- Pressure: Depending on choice of valve head
- Temperature: Depending on choice of valve head

### Net Weight

- kg/lbs: 0.14 kg/0.307 lbs

### Spareparts

- 150830: 10 PACK O-RING SILICONE 16 x 3

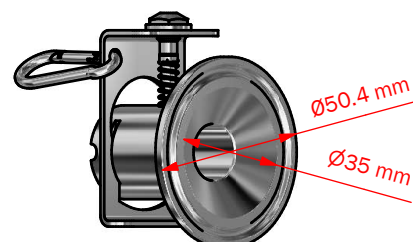
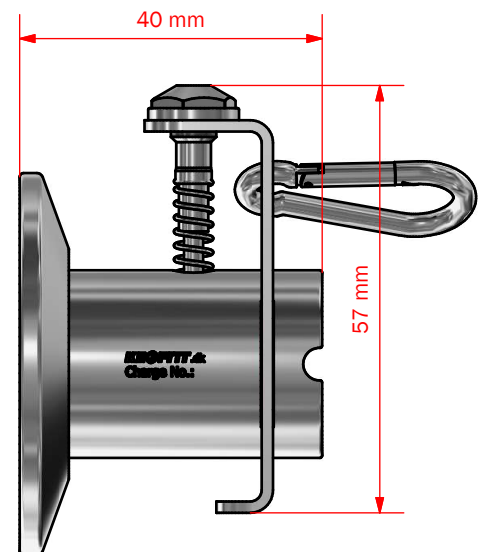

\*For further information and download please visit [www.keofitt.dk](http://www.keofitt.dk)

KEOFITT A/S reserves the right to change technical data without notice! Valid version of the data sheets is available on [www.keofitt.dk](http://www.keofitt.dk).