

# 10 PACK MEMBRANE EPDM 4KAI/BASIX/M4

**ART. NO. 400052**

## GENERAL



KEOFITT has the widest selection of spare parts and accessories to complete your sampling system.  
The patented membrane design is an essential part of the hygienic design of the KEOFIT sampling valves.



## FEATURES



Compatible with all KEOFIT M4 & 4KAI valve heads and Basix equipped with EPDM membrane

## CERTIFICATION\*

- EU EC 1935/2004 · EU EC 2023/2006 · DK No. 1248 10/2018 · FDA CFR 21 §177.2600 · USP Class VI
- REACH · RoHS · ADI Free · Keofitt DoC

## TECHNICAL DATA

### Material (process contact)

Type:	EPDM, BLACK (#310052)
Hardness, DIN 53 505 [Shore A]:	62 ± 3
Tensile strength, ISO 37 [MPa]:	20 ± 3
Elongation at break, ISO 37 [%]:	400 ± 60
M100, ISO 37 [MPa]:	3.1 ± 0.5
Tear strength, ISO 34-1 [N/mm]:	36 ± 5
Density, ISO 2781 [g/ml]:	1.08 ± 0.01

Temperature in dry atmospheric air [°C/°F]:	-40 - +140 / -40 - +284
Compression set, ISO 815, 70°C/24 h/25%/30 min. [%]:	13 ± 2

Wear resistance:	3
Resistance to weather and ozone:	4
Resistance to hydrolysis:	4
Resistance to chemicals (acids/bases):	3
Resistance to oil:	1
Permeability (gas):	1

4: Excellent 3: Good 2: Fair 1: Poor

Net weight (kg/lbs):	0.00069 kg/0.00152 lbs
----------------------	------------------------

## SERVICE TIME

Average service life of a EPDM membrane is 2-3 months, but depends very much on operating conditions and choice of cleaning method and sterilization - actual life expectancy must be experimentally determined by the user.



Batch No.

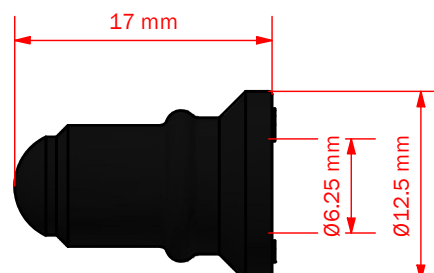

\*For further information and download please visit [www.keofitt.dk](http://www.keofitt.dk)

KEOFITT A/S reserves the right to change technical data without notice! Valid version of the data sheets is available on [www.keofitt.dk](http://www.keofitt.dk).