

## HOSE PIECE W9 F/WELDING

ART. NO. 700108

### GENERAL



KEOFITT has the widest selection of spare parts and accessories to complete your sampling system.



Compatible with all KEOFIT sampling valves

### FEATURES



Fitting: W9 hose piece



Inlet / Outlet: Welding end

### CERTIFICATION

· 3.1 Material Certificate

### TECHNICAL DATA

#### Material (product contact)

· Steel parts                      AISI 316L (1.4404)

#### Material (without product contact)

· Steel parts                      AISI 316L (1.4404)

#### Surface Treatment

- Outside                      Electropolished Ra <=1.0 µm  
- Inside (wetted surface)      Electropolished Ra <=0.5 µm

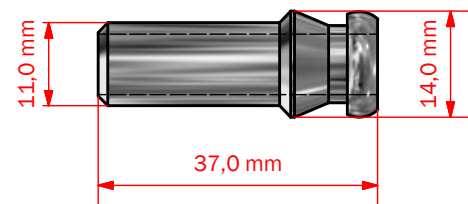

#### Pressure & Temperature

· Pressure                      0 - 2 bar (g) / 0 - 29 psi (g) 1 -  
· Temperature                      130 °C / 34 - 266 ° F

#### Net Weight

· Kg/lbs                      0,016 kg / 0,03 lbs

