

# MEMBRANE PTFE SESAME w/EPDM O-RING

ART. NO. 890055

## GENERAL



KEOFITT has the widest selection of spare parts and accessories to complete your sampling system.  
The patented membrane design is an essential part of the hygienic design of the KEOFIT sampling valves.



## FEATURES



Compatible with all KEOFIT SESAME valve heads equipped with PTFE membrane

## CERTIFICATION\*

- EU EC 1935/2004 · EU EC 2023/2006 · EU EC 10/2011 · DK No. 1248 10/2018 · FDA CFR 21 §177.1550
- USP Class VI · ADI Free · Keofitt DoC

## TECHNICAL DATA

### Material (process contact)

Type:	PTFE, WHITE (#890055)
Tensile strength, ASTM D 4894-98a [psi/bar]:	4800/330
Elongation at break, ASTM D 4894-98a [%]:	450
Density, ASTM D 4894-98a [g/cc]:	2.16
Service Temperature Range [°C/°F]:	-200 - +260 / -328 - +500
Deformation under Load, ASTM D 621 [%]:	
2175 psi - 24 h	9
2175 psi - 100 h	10
2175 psi - permanent	4.5
Flammability, UL94	V-0
Melt point, initial, ASTM D 4894-98a [°C/°F]:	342±10/647±50
Net weight [kg/lbs]:	0.007 kg/0.015 lbs

### Material (without process contact)

- O-ring
- EPDM, BLACK (#880830)
- EU EC 1935/2004 · EU EC 2023/2006 · DK No. 1248 10/2018
  - FDA CFR 21 §177.2600 · USP Class VI · REACH · RoHS · ADI Free

## SERVICE TIME

Average service life of a PTFE membrane is 12 months, but depends very much on operating conditions and choice of cleaning method and sterilization - actual life expectancy must be experimentally determined by the user.

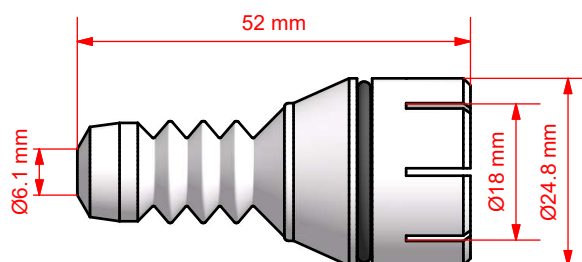

\*For further information and download please visit [www.keofitt.dk](http://www.keofitt.dk)